

WE ENGINEER YOUR SOLUTIONS!

NOTE OF INFORMATION

To : All Bidders	Project : MTEC SNESI KONDRE
Date : 08 January 2025	Project # : EMSAGS-0824-C
	Discipline : Design & Engineering
	Ref. : MTEC-0824-C-MoM01

The site instruction for the project MTEC SNESI KONDRE was held on Wednesday 08 January 2025 at Snesikondre in the district Sipaliwini.

The questions can be send by email to info-EMSAGS@nimos.org no later than Wednesday, January 15th, 2025, at 16:00 hrs.

The tender submission will be send by email to info-EMSAGS@nimos.org, no later than Friday January 31st, 2025, at 16:00 hrs.

Present during site instructions:

CODECO N.V.	EMSAGS	CONTRACTORS
Mr. A. Dassasingh Ms. S. Rathipal Mr. D. Jewlal	Mr. E. Sosrojoedo	MV&V NV – V. Jankie – A. Jankie Bouwbedrijf Ramlal – J. Liu TCF n.v. – G. Louis

OPENING

Mr. A. Dassasingh starts the meeting at 12:00 pm. by welcoming all participants and then giving a brief presentation of the project to the contractors.

NOTIFICATIONS AND ADDITIONS

1. For the demolition works, a demolition plan needs to be submitted prior start of the works.
2. For the electrical installations all attributes and accessories should be included in the price.
3. For the water installation, the pump will be placed on the platform with a steel cage anchoring in the platform and roof construction.
4. In the biweekly timeline the names of personnel, function, performance of activities and the purchase list with materials and specifications to be used should be stated.
5. All information of the personnel should be submitted such as the names, functions and the activities that they will be performing.

WE ENGINEER YOUR SOLUTIONS!

6. In the detailed timeline the duration of each activity should be stated clearly in days and percentages.
7. For the air-condition installations the cables and pipes should be placed in cable ducts with corresponding fittings or attachments.
8. For the air-conditioning the following information that is not available in the drawings are:
 - AC1 for the training area is 18000 BTU.
 - AC2 and AC3 for the offices are each 9000 BTU.
 - AC4 for the lobby is 12000 BTU.

LG split system inverter V series classic air-conditioners.

9. The height of the socket outlets should be 70cm from the floor level and the heights of the light switch should be 150cm from the floor level.
10. For the kitchen the sockets should be waterproof.
11. For the toilet areas, the area of the ornamental stones and at the rear of the building the gap between wall and roof should be closed with fiberglass mosquito mesh in such way that rodents and insects can't enter the ceiling. To be approved by Supervision.
12. Both containers onsite and the temporary fence will be placed behind the new fence on the back of the property.
13. Demolished material must be disposed at a location provided by the Contractor for approval from Supervision.
14. An additional post must be included in the BoQ for the removal of vegetation around the building. At the left and right of the building in a diameter of 5m outside the new fence and at the rear of the building in a diameter of 15m outside the new fence.
15. The steel structure including purlins and joints of the high building should be cleaned and coated again.
16. The opening between the high building and the low building should be closed with flashing.
17. Cracks to be chipped open and rectified with plaster layer.
18. The manhole locations will be in the storage room and at the back of the corridor leading to the offices.
19. 1 row of masonry with blinding concrete should be included in the price for new garage floor.
20. The air-conditioning height will be at 2.5m from the finished floor.
21. The existing floor should be chipped before casting of the new floor of 50mm.
22. An additional post must be included for an entrance 6m wide on both sides of the property where the fences will be placed.
23. Accommodation is the responsibility of the contractor. The terrain may be used with consideration of health and safety issues.

WE ENGINEER YOUR SOLUTIONS!

24. In §3.3.7 point 7 will be replaced with: The IPE-160 will be cleaned with a corrosion resistant chemical.
25. In §3.3.7. the rebars must be drilled and anchored with a chemical anchoring (Simpson Tie Glue). To be approved by Supervision.

QUESTIONS AND ANSWERS

1. Is there an advance payment available for this project?

Answer: There is a possibility for advance payment. This will be explained in detail in the contract.

2. Can the time for submission be extended?

The project is too comprehensive to prepare a detailed quotation within the deadline.

Answer: The submission date has been extended to Friday, 31st of January 2025.

3. Can there be only one penalty for late delivery instead of other milestones as well?

Answer: The penalties are only as a means of ensuring that the works do not exceed the planned timeframe. Only by completing the milestones the final completion date can be ensured.

4. Dimensions of the new garages are missing. What are the dimensions

Answer: See drawing sheet 2 for revised drawing.

5. The elevation of the ridge of the high building

Answer: The elevation of the ridge is 5770mm. Site measurements can differ.

6. Dimensions of the Hall & Room are missing

Answer: See drawing sheet 2 for revised drawing.

7. Detail dimensions missing from existing toilet group

Answer: See drawing sheet 2 for revised drawing.

8. To which elevation should the toilet group be tiled?

Answer: Wall tiles should be tiled up to door height 2100mm. Site measurements can differ.

9. Does the item in the table of contents below relate to the electrical installation or the solar installation?

Answer: For both the installation.

10. What system should be used for electrical installation? American / European

WE ENGINEER YOUR SOLUTIONS!

Answer: The Amerikan system should be used for electrical installations.

11. What are the consumption capacities of devices/equipment that will be used in this building?

Answer: Air conditioners/ Kitchen equipment/ Lights/ Fans/ Water pump/ Mobile charger/ Computers

12. Can the roof be used as to install the solar panels?

*Answer: The existing solar panels are on the roof. The new one can also be placed on the roof.
Location to be decided according to the installation.*

13. Is the Storage Room in the floor plan drawing of the electrical system intended for the Solar Installation?

Answer: No, the installation (in blue) will be done in the hall and the window (in green) will be moved towards the door (in red). Measurements to be checked onsite.

See picture for the location.

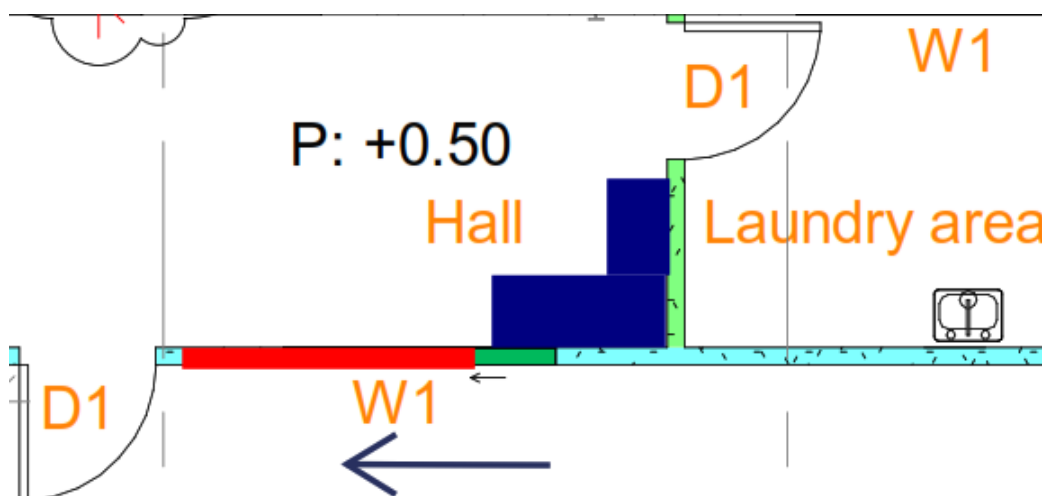

14. Is the air conditioning on only during the day?

Answer: Yes, the air-conditioning will be on for 6 hours during the day.

15. Words are missing from page 18 related to "DEMOLITION OF EXISTING PVC PANELS".

Answer: See additional document for missing information.

16. Can we as contractors mix and pour our own blinding concrete?

Answer: Yes, but a batch needs to be approved prior pouring to make sure the batch is mixed with the correct quantity of materials.

WE ENGINEER YOUR SOLUTIONS!

17. Why is it necessary to test blinding concrete per pour as it has no constructive values for the slab.

Answer: No, it is not necessary to test the blinding slab. Only the levels will be checked.

18. Should the garage floors be connected to the existing floor?

Answer: No, the new garage floors will not be connected to the existing.

End of note of information.

Paramaribo, 21 January 2025



CODECO N.V.

S. Rathipal

Junior Engineer